

BΛSE

The starting point to create the ideal workspace

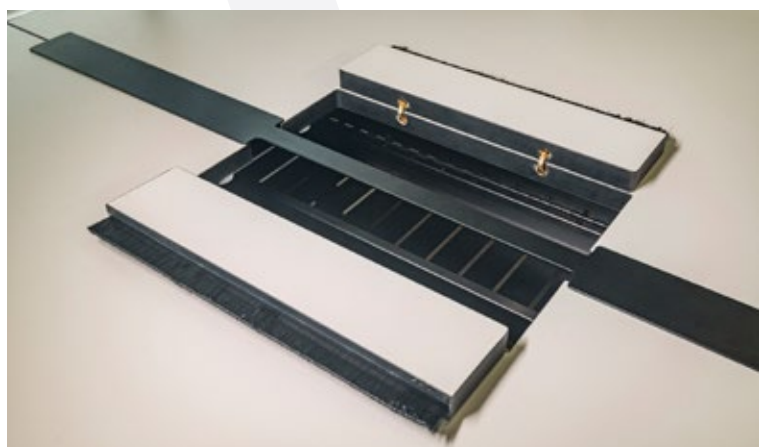

**It's everything you want a
workstation
to be...
Quality, Design & Value**

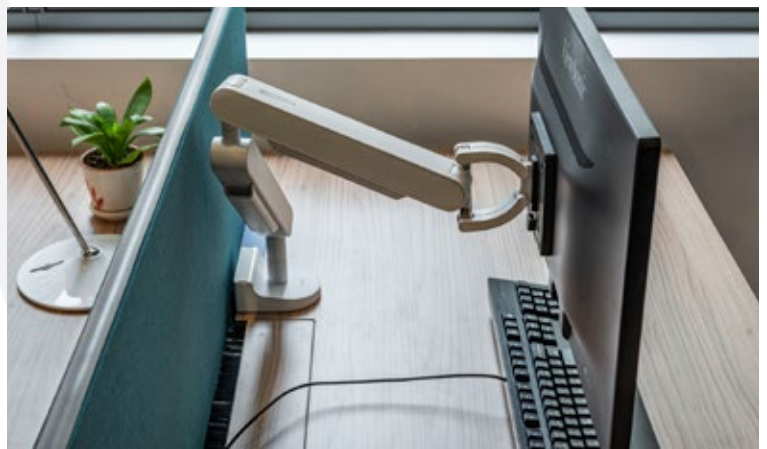

THE SELECTION OF FINISHES

Surfaces by Formica

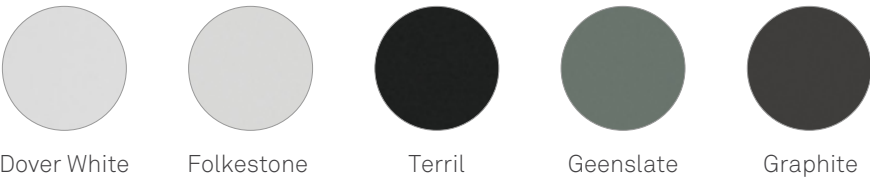

Worktop Colors

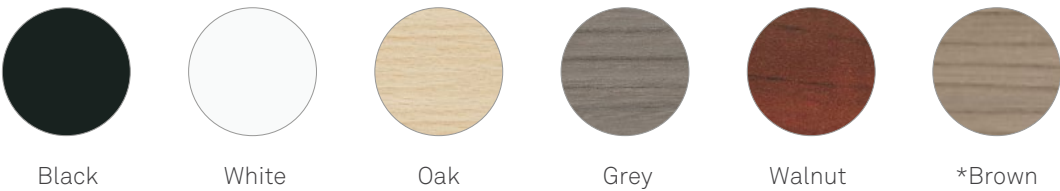

Desk Screen & Divisions by Woven Image

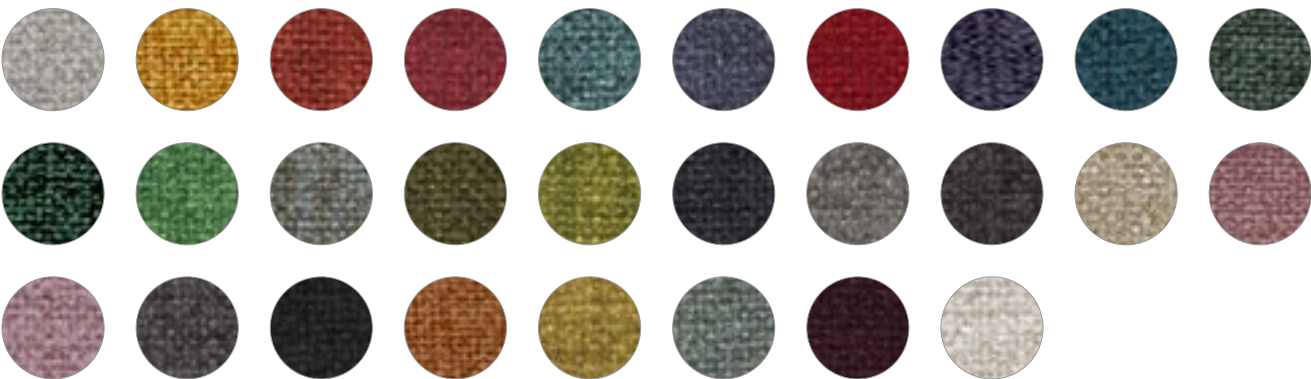

Base Colors

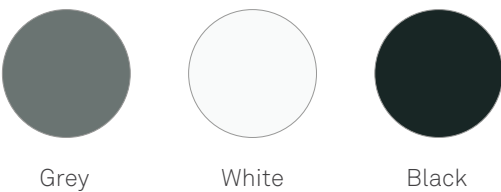

Bolon Carpets (Not included in standard table)

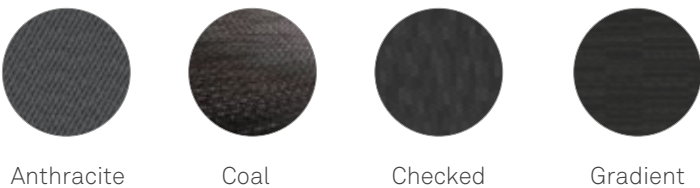

*10% Additional



THE OPTIONS

	BASE Low x2 Clusters	BASE + Low x4 Clusters	BASE High x2 Clusters	BASE + High x4 Clusters
Single Frame	•		•	
Cluster Frame		•		•
Standard Worktop	•		•	
Upgraded Worktop		•		•
Standard Cable Tray	•		•	
Upgraded Cable Tray		•		•
Metal Infil	Optional	Optional	Optional	Optional
Standard Panel	•		•	
Customized Panel		•		•
Standard Carpet			Client own carpet	
Customized Carpet				•
PRICE HKD	\$4,915	\$16,970	\$8,235	\$22,397
	*2,457/station	*4,242/station	*4,117/station	*5,599/station



THE PRODUCT DETAILS

Low Table 2 Clusters

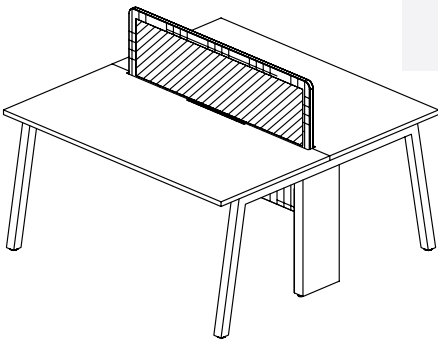

2 Clusters
Width 1500mm
Depth 11480mm
Height 720mm

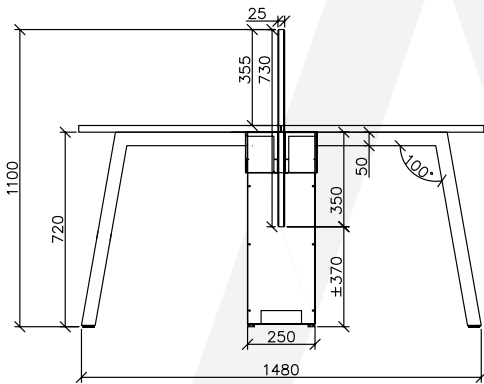
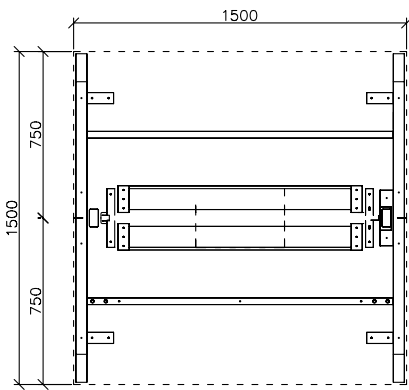

Low Table 4 Clusters

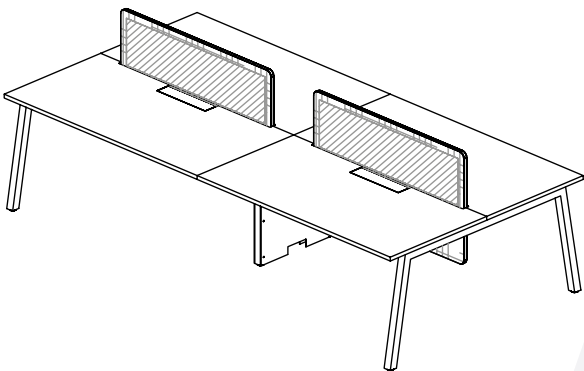

4 Clusters
Width 3200mm
Depth 1500mm
Height 720mm

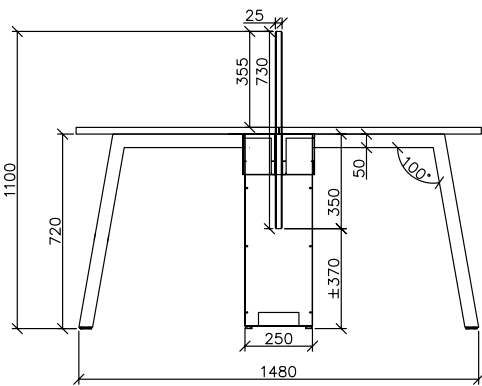
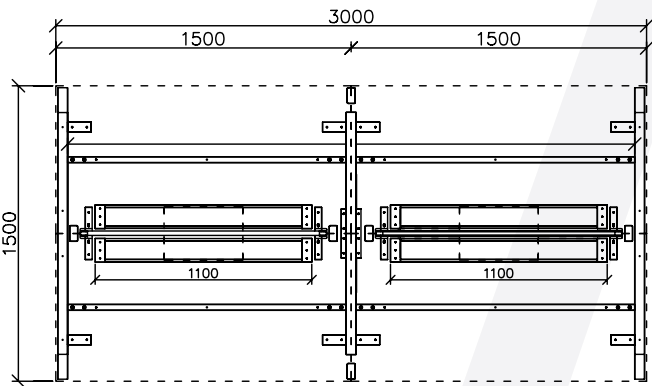

THE PRODUCT DETAILS

High Table x2 Clusters

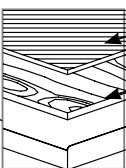
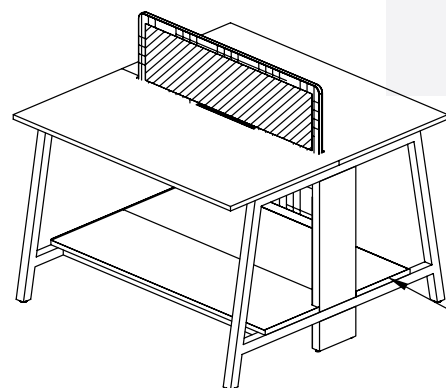

Carpet
*provided by other
MDF

2 Clusters
Width 1500mm
Depth 1500mm
Height 1355mm

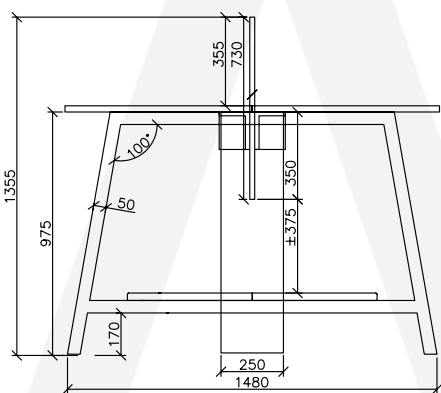
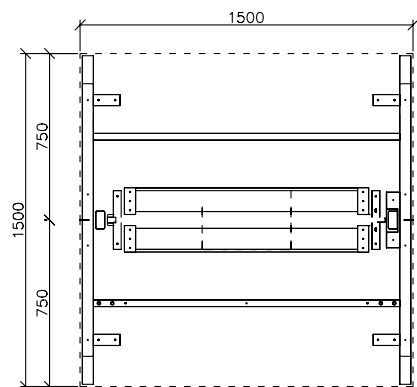

High Table x4 Clusters

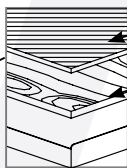
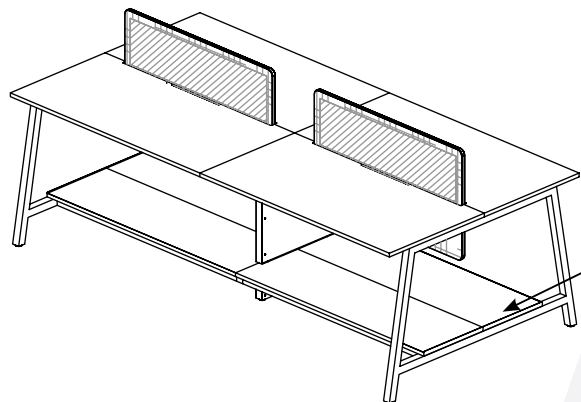

Carpet
*provided by other
MDF

4 Clusters
Width 3200mm
Depth 1600mm
Height 1000mm

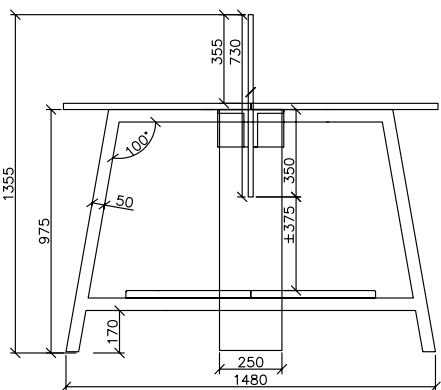
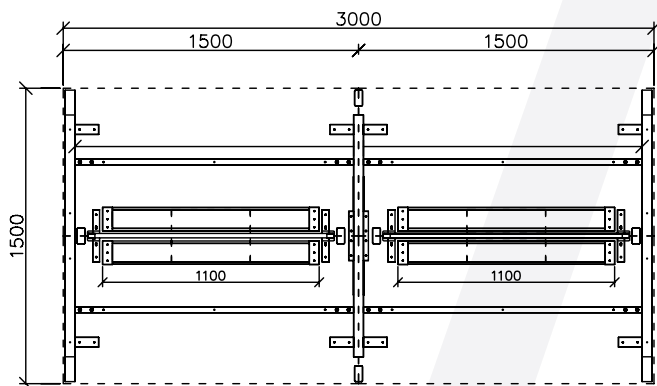

THE PRODUCT DETAILS

Cable Management (Cover)

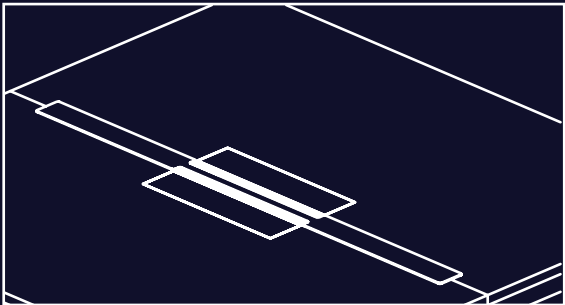
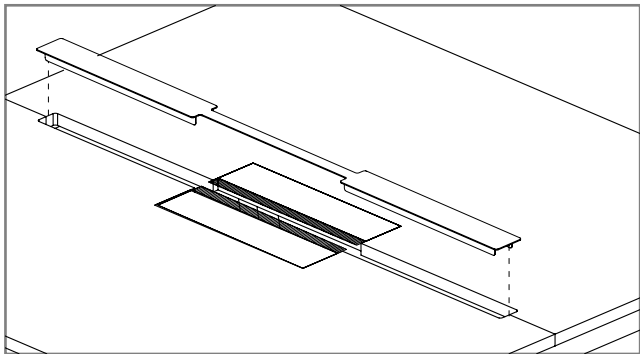

Cable Management

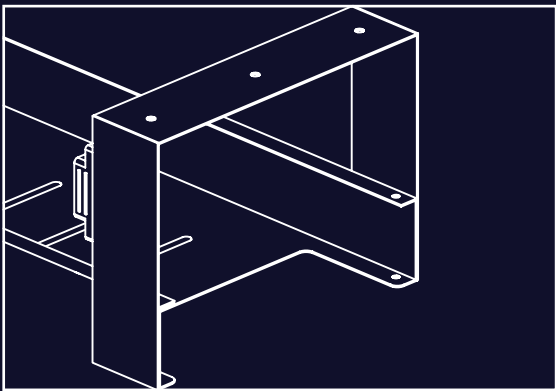
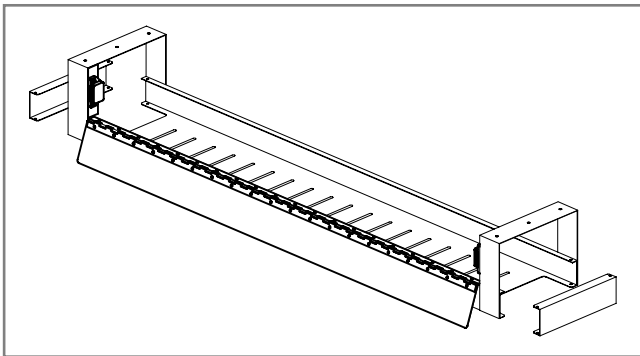

Panel

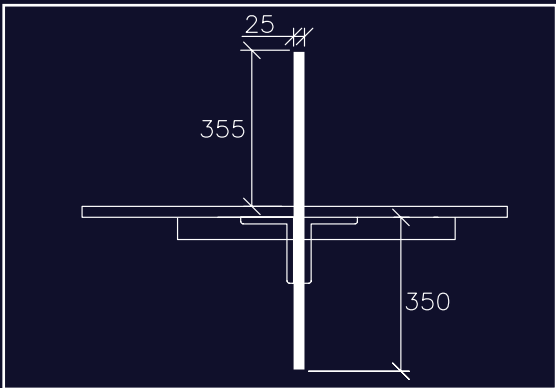
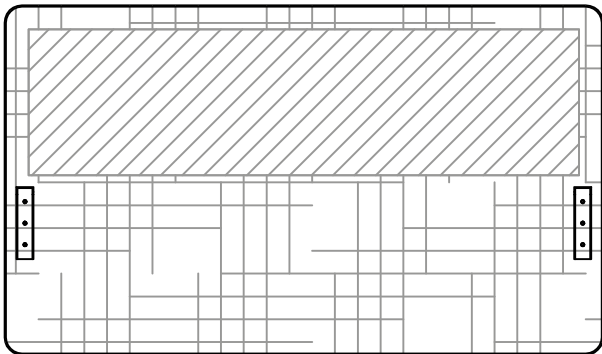



BASE is the starting point to create the ideal workspace

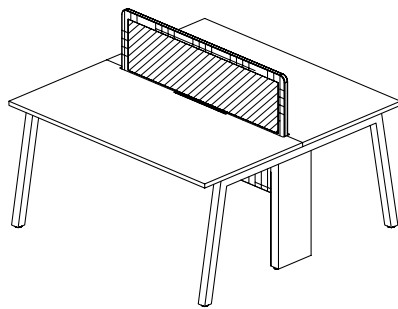

**Low Desk
2 Clusters**
Width 1500mm
Depth 11480mm
Height 720mm

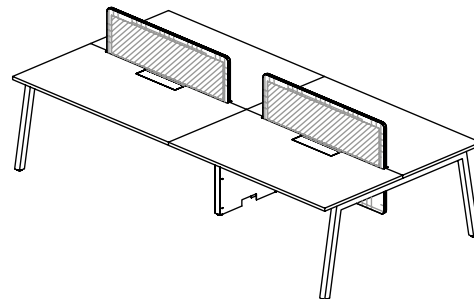

**Low Desk
4 Clusters**
Width 3200mm
Depth 1500mm
Height 720mm

MATERIALS

BASE is composed of Steel (85%), Wood (10%) and Fabric (5%) for a typical cluster of 4

RESOURCE USE & RECYCLED CONTENT

Products are designed for long life and resource reuse. At the end of life BASE is approximately 45% recyclable when fully separated.

Packing materials include cardboard, polyethylene and polypropylene, all of which can be recycled and diverted from landfill.

REGIONAL MATERIALS

Product is manufactured in Shenzhen, China and assembled on site minimizing shipping and trucking volume as much as possible.

Approximately 50% is manufactured regionally by an ISO 9001 and ISO 14001 certified factory.

INDOOR ENVIRONMENTAL QUALITY (IEQ)

Low -Emitting materials, paints and coatings are used. All powder-coating is free from VOC emissions.

Special finishes by



BOLON





BASE is the starting point to create the ideal workspace

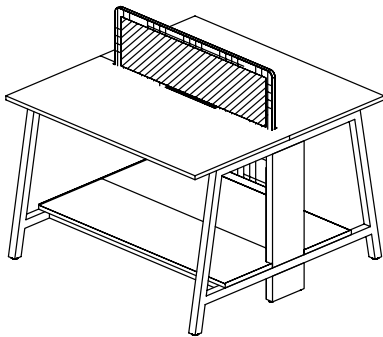

**High Desk
2 Clusters**
Width 1500mm
Depth 1500mm
Height 1355mm

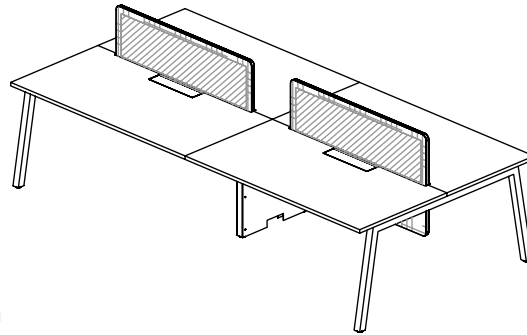

**High Desk
4 Clusters**
Width 3200mm
Depth 1600mm
Height 1000mm

MATERIALS

BASE is composed of Steel (85%), Wood (10%) and Fabric (5%) for a typical cluster of 4

RESOURCE USE & RECYCLED CONTENT

Products are designed for long life and resource reuse. At the end of life BASE is approximately 45% recyclable when fully separated.

Packing materials include cardboard, polyethylene and polypropylene, all of which can be recycled and diverted from landfill.

REGIONAL MATERIALS

Product is manufactured in Shenzhen, China and assembled on site minimizing shipping and trucking volume as much as possible.

Approximately 50% is manufactured regionally by an ISO 9001 and ISO 14001 certified factory.

INDOOR ENVIRONMENTAL QUALITY (IEQ)

Low -Emitting materials, paints and coatings are used. All powder-coating is free from VOC emissions.

Special finishes by



BOLON

